



330 Poole Road

Branksome, Poole, BH12 1AS

£1,100 Per Month



Road Map



Hybrid Map



Terrain Map



Floor Plan

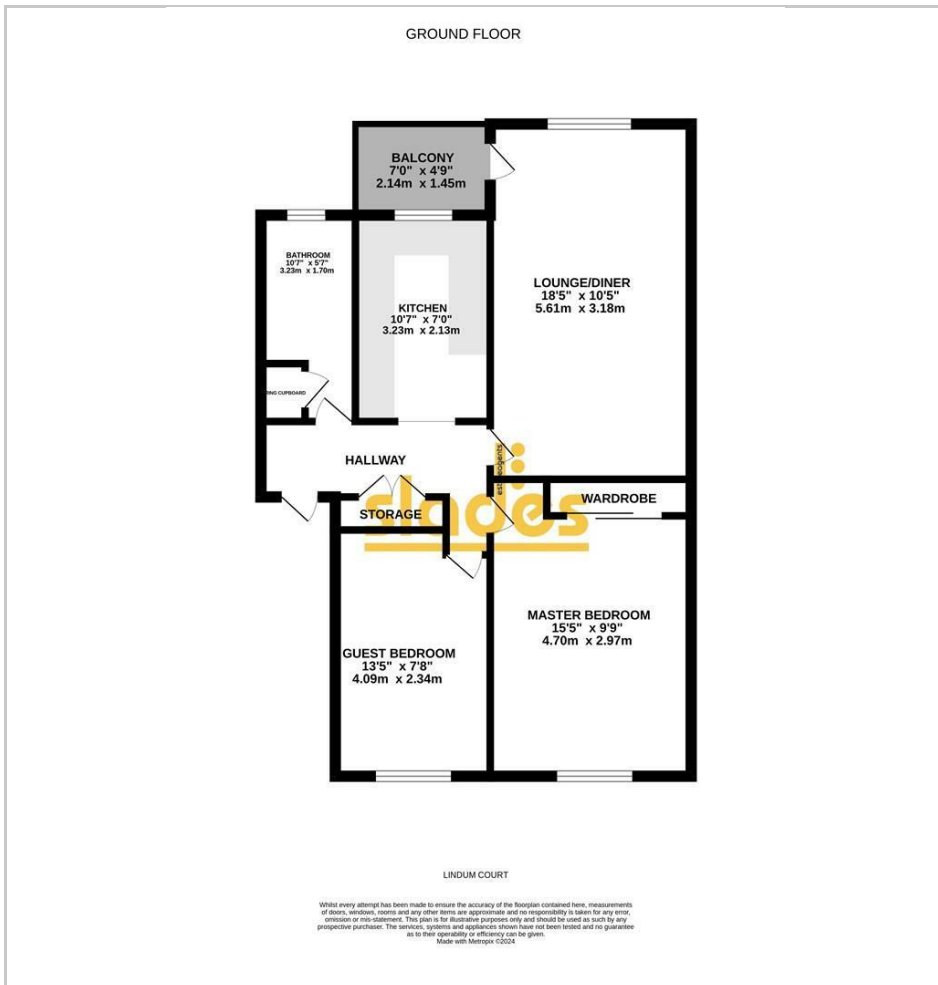

- SHORT LEVEL WALK TO WESTBOURNE
- SPACIOUS GROUND FLOOR APARTMENT
- 2 DOUBLE BEDROOMS
- SPACIOUS KITCHEN & BATHROOM
- LIVING ROOM WITH DIRECT ACCESS TO TERRACE & GARDEN
- OFF ROAD PARKING
- UNFURNISHED
- AVAILABLE NOW

Viewing

Please contact our Slades Estate Agents Office on 01202548855 if you wish to arrange a viewing appointment for this property or require further information.



These particulars, whilst believed to be accurate are set out as a general outline only for guidance and do not constitute any part of an offer or contract. Intending purchasers should not rely on them as statements of representation of fact, but must satisfy themselves by inspection or otherwise as to their accuracy. No person in this firm's employment has the authority to make or give any representation or warranty in respect of the property.

301 Wimborne Road, Bournemouth, BH9 2AA
Tel: 01202548855 Email: info@sladesproperty.co.uk <https://www.sladesproperty.co.uk>

Energy Efficiency Graph

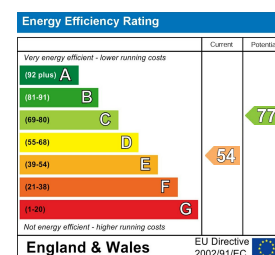

**** UNFURNISHED ** A bright and spacious 2 double bedroom GROUND FLOOR apartment just a short level walk into Westbourne Village and West Overcliff.**



Lindum Court is a development of 2 blocks of 24 flats (48 in total), The particular flat offered for sale is located on the ground floor of the more prestigious south facing block fronting onto Poole Road overlooking the well maintained communal gardens. The accommodation with approximate room sizes comprises of a well presented communal entrance hall with door to flat 2.

ENTRANCE HALL

LIVING ROOM

18'5 x 10'5 (5.61m x 3.18m)

KITCHEN

10'7 x 7' (3.23m x 2.13m)

BEDROOM ONE

15'5 x 9'9 (4.70m x 2.97m)

BEDROOM TWO

13'5 x 7'8 (4.09m x 2.34m)

BATHROOM

10'7 x 5'7 (3.23m x 1.70m)

OUTSIDE

the property is set within a well maintained communal grounds which can be accessed from the private terrace.

